

MAIN FEATURES

Cost effective encoder for asynchronous motors, suitable for elevators and stage machinery.

- 3 channel encoder (A / B / Z) up to 2500 ppr
- Power supply up to +28 V DC with several electrical interfaces available
- Up to 105 kHz output frequency
- Cable output, connector available on cable end
- Sturdy mechanic
- Up to 40 mm bore diameter
- Shaft fixing by collar clamping



ORDERING CODE

EH 88PE 1024 S 5/28 P 30 X 3 PR .XXX

SERIES incremental encoder series EH											
MODEL through hollow shaft with spring 88PE through hollow shaft for torque arm fixing 88PET please refer to Accessories section for torque arm											
RESOLUTION ppr from 500 to 2500 see table for pulses availability											
ZERO PULSE without zero pulse S with zero pulse Z											
POWER SUPPLY (with L electrical interface) 5 V DC 5 5 ... 28 V DC 5/28											
ELECTRICAL INTERFACE push-pull P line driver L power supply 5/28V - output RS-422 RS											
BORE DIAMETER mm 25 mm 30 (mod. PE) mm 35 (mod. PE) mm 38 (mod. PE) mm 40											
ENCLOSURE RATING IP 54 X											
MAX ROTATION SPEED 3000 rpm 3											
OUTPUT TYPE radial cable (standard length 0,5 m) PR preferred cable lengths 1,5 / 2 / 3 / 5 / 10 m, to be added after OUTPUT TYPE (eg. PR5)											
VARIANT custom version XXX											

88 PE

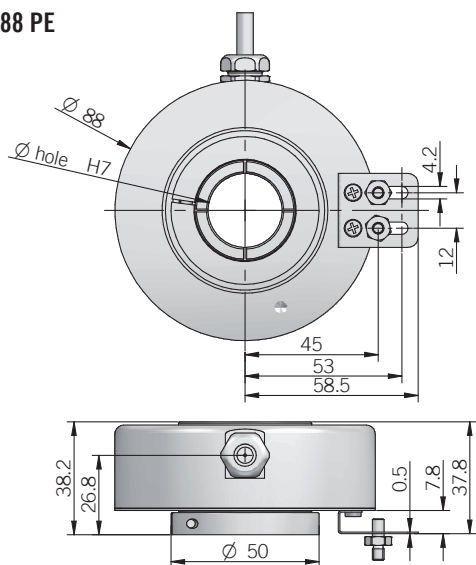

for torque pin please refer to Accessories section

88 PET

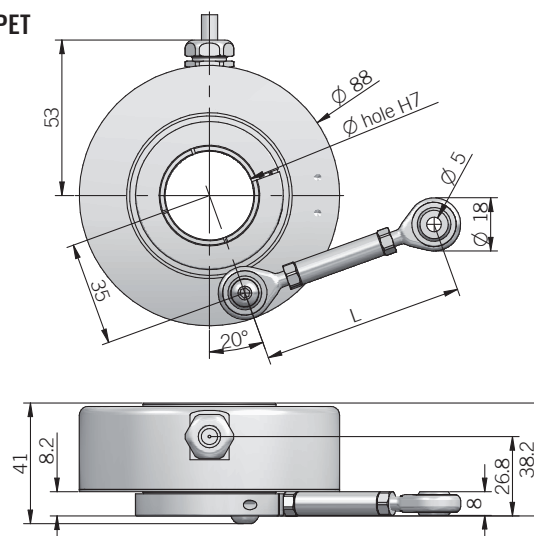

torque arm not included, please refer to Accessories section

OPTIONAL TORQUE STOP

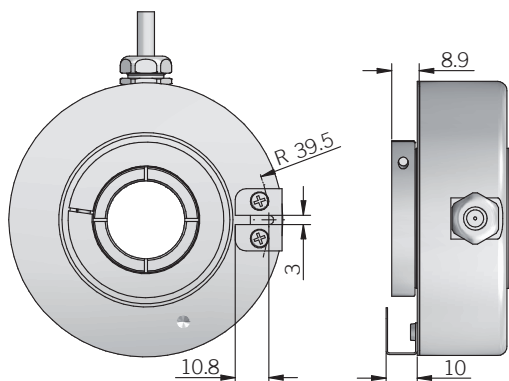

dimensions in mm

for torque stop please refer to Accessories section

ELECTRICAL SPECIFICATIONS

Resolution	from 500 to 2500 ppr
Power supply	5 = 4,5 ... 5,5 V DC 5/28 = 4,5 ... 30 V DC (reverse polarity protection)
Power draw without load	800 mW
Max load current	20 mA / channel
Output type*	push-pull / line driver HTL (AEC-7272) line driver RS-422 (AELT-5000 or equivalent)
Max output frequency	105 kHz
Counting direction	A leads B clockwise (shaft view)
Electromagnetic compatibility	according to 2014/30/EU directive
RoHS	according to 2011/65/EU directive
UL / CSA	certificate n. E212495

* for further details please see OUTPUT LEVELS under TECHNICAL BASICS section

MECHANICAL SPECIFICATIONS

Bore diameter	ø 25 / 30 / 35 / 38 / 40 mm
Enclosure rating	IP 54 (IEC 60529)
Max rotation speed	3000 rpm
Shock	50 G, 11 ms (IEC 60068-2-27)
Vibration	10 G, 10 ... 2000 Hz (IEC 60068-2-6)
Moment of inertia	45 x 10 ⁻⁶ kgm ² (10,68 x 10 ⁻⁴ lbfm ²)
Starting torque (at +20°C / +68°F)	< 0,02 Nm (2,83 Ozin)
Bearing stage material	EN-AW 2011 aluminum
Shaft material	up to ø 38 mm: EN-AW 2011 aluminum ø 40 mm: 1.4305/AISI 303 stainless steel
Housing material	EN-AW 2011 aluminum
Bearings	2 ball bearings
Bearings life	10 ⁹ revolutions
Operating temperature	-30° ... +85°C (-22° ... +185°F)
Storage temperature	-30° ... +85°C (-22° ... +185°F)
Fixing torque for collar clamping	1 Nm recommended (142 Ozin)
Weight	350 g (12,35 oz)

RESOLUTIONS

500 - 512 - 720 - 1000 - 1024 - 1440 - 2500

please directly contact our offices for other pulses, preferred resolutions in bold

CONNECTIONS

Function	Cable P	Cable L / RS
+V DC	red	red
0 V	black	black
Ch. A	green	green
Ch. A-	/	brown
Ch. B	yellow	yellow
Ch. B-	/	orange
Ch. Z	blue	blue
Ch. Z-	/	white
⏏	shield	shield